



Page station 5X



User manual

IMPORTANT SAFETY INSTRUCTIONS

CAUTION!

THIS PRODUCT UTILIZES A LASER. USE OF CONTROLS OR ADJUSTMENTS OR PERFORMANCE OF PROCEDURES OTHER THAN THOSE SPECIFIED HEREIN MAY RESULT IN HAZARDOUS RADIATION EXPOSURE. DO NOT OPEN COVERS AND DO NOT REPAIR YOURSELF. REFER SERVICING TO QUALIFIED PERSONNEL.

WARNING:

TO REDUCE THE RISK OF FIRE, ELECTRIC SHOCK OR PRODUCT DAMAGE, DO NOT EXPOSE THIS APPARATUS TO RAIN, MOISTURE, DRIPPING OR SPLASHING AND THAT NO OBJECTS FILLED WITH LIQUIDS, SUCH AS VASES, SHALL BE PLACED ON THE APPARATUS.



When using this electronic device, basic precautions should always be taken, including the following:

1. Read all instructions before using the product.
2. Do not use this product near water (e.g., near a bathtub, washbowl, kitchen sink, in a wet basement or near a swimming pool etc).
3. Use this device when you are sure that paging microphone has a stable base and it is fixed securely.
4. This product, in combination with loudspeakers and amplifier may be capable of producing sound levels that could cause permanent hearing loss. Do not operate for a long period of time at a high volume level or at a level that is uncomfortable. If you experience any hearing loss or ringing in the ears, you should consult with otorhinolaryngologists. The product should be positioned so that proper ventilation is maintained.
5. The product should be located away from heat sources such as radiators, heat vents, or other devices (including amplifiers) that produce heat.
6. The product should be connected to amplifier that is described in the operating instructions only.
7. RJ45 cable should be undamaged.
8. Care should be taken so that objects do not fall into, and liquids would not be spilled through, the enclosure's openings.
9. The product should be serviced by qualified service personnel if:
 - RJ45 cable or the plug has been damaged.
 - Objects have fallen into or liquid has been spilled on the product.
 - The product has been exposed to rain.
 - The product has been dropped or the enclosure damaged.
10. There are some areas with high voltage inside, to reduce the risk of electric shock do not remove cover of the paging microphone. The cover should be removed by the qualified personnel only.

No user serviceable parts inside.

CONTENTS:

Before you start

Introductions	4
Features	4
What's in the box	4

Operation

Front panel	5
Rear panel	5
Function description	6

Controls and connectors

RJ45 connector's pinout	7
Connection example	7

Specifications

General specifications	8
------------------------	---

Introduction

Thank you for purchasing the Page station 5X. Please read this manual carefully before using the microphone to ensure proper use of the system. This manual describes the Page station 5X features, functions, applications, user interface, technical specifications, and installation procedures.

Features

- 5 zone paging
- Condenser microphone capsule
- Chime
- Clip indicator
- Microphone gain control
- Lock and unlock modes

What's in the box

The accessories which are included in the box are:

- Page station 5X
- Gooseneck microphone
- User manual

5 Operation

Front Panel

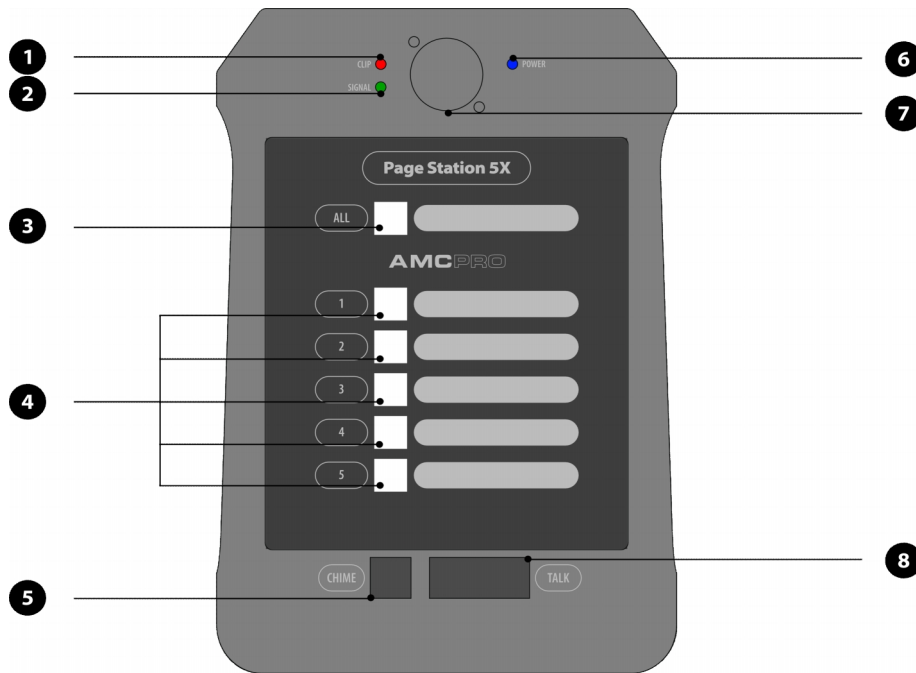

1. Signal clipping indicator
2. Signal indicator
3. All zone selection switch
4. Zone selection switch

5. Chime switch
6. Power indicator
7. Microphone connector
8. Talk switch

Rear Panel

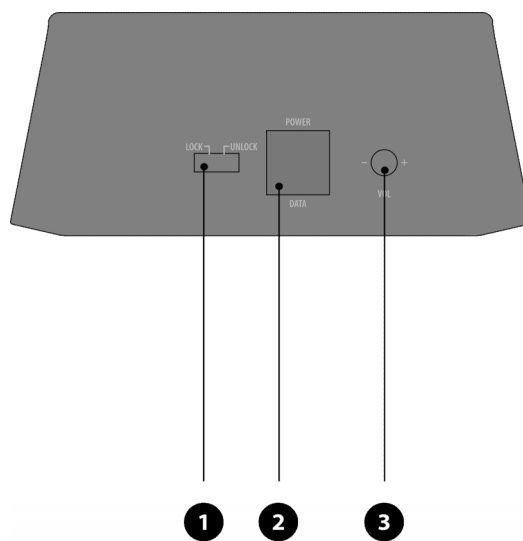

1. Lock / unlock switch
2. RJ45 connector

3. Gain control

Functions description

CLIP INDICATOR

Lights up if microphone output signal is distorted. Reduce page station volume to ensure undistorted output signal.

SIGNAL INDICATOR

Indicates audio signal in the page station output.

ALL ZONE SELECTION SWITCH

This switch activates all zones for broadcasting announcement. Please note: if this button is not active (no reaction if you pressed it) please check lock/unlock switch, maybe keyboard is locked!

ZONE SELECTION SWITCH

These switches control amplifier's output in order to broadcast announcement to the desired zone. Please note: if these buttons are not active (no reaction if you pressed these buttons) please check lock/unlock switch, maybe keyboard is locked!

CHIME SWITCH

This button activates chime sound on selected zones. Chime activation disables zone selection until press and release talk button.

POWER INDICATOR

The LED lights up if the page station is powered on.

MICROPHONE CONNECTOR

Designed to connect gooseneck microphone to the page station.

TALK SWITCH

This switch is used to activate microphone in order to make announcement to the selected zones. A selected zone becomes active only at the moment that this button is pressed. After button release, selected zones deselect automatically, if lock/unlock button is set to the position "UNLOCK".

GAIN CONTROL

Turn clockwise to increase or counterclockwise to decrease the page station microphone gain.

RJ45 CONNECTOR

This connector is designed to connect page station 5X to the MMA X amplifiers.

LOCK / UNLOCK SWITCH

This function allows lock to any selected combination of your zone switches. It helps to prevent accidentally zone selection and makes usage more comfortable if you make announcements to the same zones all the time.

RJ45 connector's pinout

1. + 15 Volts
2. Ground
3. - 15 Volts
4. Data -
5. Data +
6. Ground
7. Signal +
8. Signal -

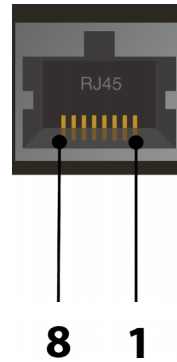

Connection example



General specifications

Power supply	± 15 V
Input sensitivity	-50 dBu
Frequency response	45 Hz – 15 kHz
Signal to noise ratio	< 90 dBu
THD	< 0,1 %
Dimensions	140 mm x 60 mm x 205 mm
Weight	0,9 kg.